

Aenderungen:
Modifiche:
ⓐ
Aggiunti
nuovi
parametri
diversi
dal
default
(F4-F8-
F9-F10-
F11)

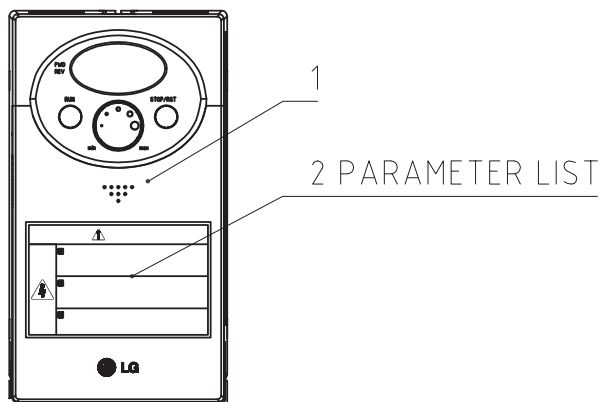

iC5 - 0.8kW - 230V - Table OP1 - 28/10/2008 - 14.53.50

-----[DRV]-----

Cmd	40.00	Hz	Keypad Frequency
Acc	4.0	sec	Acceleration time 0
Dec	4.0	sec	Deceleration time 0

-----[FU1]-----

F4	1		Stop via DC brake
F8	8.5	Hz	DC brake start frequency
F9	0	sec	DC brake wait time
F10	80	%	DC brake woltage
F11	0.5	sec	DC brake time
F14	0.1	sec	Motor Magnetizing time
F22	50.00	Hz	Base Frequency
F23	0.10	Hz	Start Frequency
F27	1		Man/Auto Torque select

-----[FU2]-----

H33	2.7	A	Motor rated current
H34	1.4	A	No load motor current
H40	3		Control mode
H46	50		Sensorless I Gain

-----[IO]-----

I12	0.00	mA	I input minimum current
I55	16		30-A/B/C output working

1	FILE DI PROGRAMMAZIONE	2	PARAMETER LIST			
	INVERTER TABLE OP1	1	LS INDUSTRIAL SYSTEMS		N5.5475	SV08-iC5-1F

Gebrauch Zchg. Usa del disegno	Stueckzahl Numero pezzi Rubrik Rubrica	Gegenstand Oggetto	Pos.	Werkstoff Materiale kg.	Gewicht/Stueck Peso/Pezzo	Bestandt. Nr. Elemento Nr.	Bemerkungen Osservazioni
-----------------------------------	---	-----------------------	------	-------------------------------	------------------------------	-------------------------------	-----------------------------

Freimass-Toleranzen/Tolleranze della misure libere	Aenderungen: Modifiche: ⓐ				Keine Nessuna Stueckliste separat Lista pezzi separata		Ersetzt durch Sostituito da Ersatz fuer Sostituisce		
	Typ: Tipo:				Massstab Scala 1:1	Gezeichnet Disegnato	VICENTINI	28-10-2008	
	INVERTER MOTOR TABLE OP1					Gepueft Controllato	Servisi	23-11-09	
					FROMMM				Gesehen Visto