

Aenderungen:
Modifiche:
ⓐ
Aggiunti
nuovi
parametri
diversi
dal
default
(F4-F8-
F9-F10-
F11)

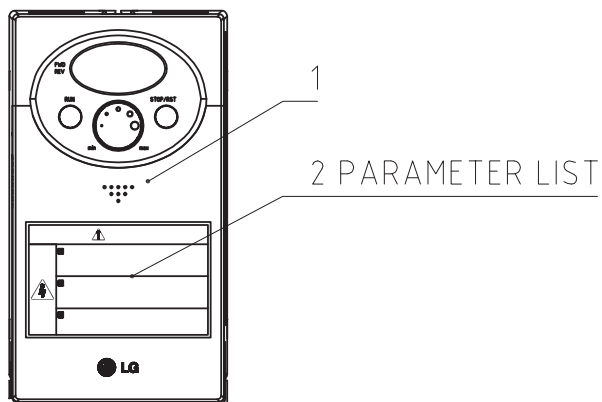

iC5 - 0.8kW - 230V - TAVOLA OP2 - 24/10/2008 - 14.54.13

-----[DRV]-----
 Acc 4.0 sec Acceleration time 0
 Dec 4.0 sec Deceleration time 0
 Frq 4 Freq. Setting mode

-----[FU1]-----
 F4 1 Stop via DC brake
 F8 8.5 Hz DC brake start frequency
 F9 0 sec DC brake wait time
 F10 80 % DC brake woltage
 F11 0.5 sec DC brake time
 F14 0.1 sec Motor Magnetizing time
 F22 50.00 Hz Base Frequency
 F23 0.10 Hz Start Frequency
 F27 1 Man/Auto Torque select

-----[FU2]-----
 H33 2.7 A Motor rated current
 H34 1.4 A No load motor current
 H40 3 Control mode
 H46 50 Sensorless I Gain

-----[IO]-----
 I12 0.00 mA I input minimum current
 I55 16 30-A/B/C output working

1	FILE DI PROGRAMMAZIONE	2	PARAMETER LIST			
	INVERTER TABLE OP2	1	LS INDUSTRIAL SYSTEMS		N5.5475	SV08-iC5-1F

Gebrauch Zchg. Uso del disegno	Stueckzahl Numero pezzi	Gegenstand Oggetto	Pos.	Werkstoff Materiale	Gewicht/Stueck Peso/Pezzo	Bestandt. Nr. Elemento Nr.	Bemerkungen Osservazioni
	Rubrik Rubrica			kg.			

Freimass-Toleranzen/Tolleranze della misure libere	Aenderungen: Modifiche: ⓐ				Keine Nessuna Stueckliste separat Lista pezzi separata	Ersetzt durch Sostituito da Ersatz fuer Sostituisce		
	Typ: Tipo:				Massstab Scala 1:1	Gezeichnet Disegnato	VICENTINI	28-10-2008
	INVERTER MOTOR TABLE OP2					Gepuert Controllato	Servisi	23-11-09
					FROMMM			