

Aenderungen:
 Modifiche:
 ⓐ
 Modificata
 scritta
 da 0.8Kw
 a 0.4Kw

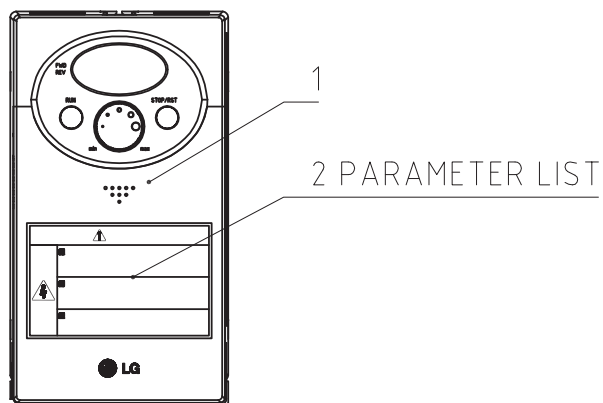

iC5 - 0.4kW - 230V - Carriage OP1 - 25/02/2009 - 14.53.50

-----[DRV]-----			
Acc	0.1	sec	Acceleration time 0
Dec	0.1	sec	Deceleration time 0
Frq	2		Freq. Setting mode
-----[FU1]-----			
F14	0.1	sec	Motor Magnetizing time
F22	50.00	Hz	Base Frequency
F23	0.10	Hz	Start Frequency
-----[FU2]-----			
H33	1.3	A	Motor rated current
H34	0.8	A	No load motor current
H40	3		Control mode
-----[IO]-----			
I3	20.00	Hz	Frequency related to I2
I12	0.00	mA	I input minimum current
I55	16		30-A/B/C output working

1	FILE DI PROGRAMMAZIONE	2	PARAMETER LIST			
	INVERTER CARRIAGE OP1	1	LS INDUSTRIAL SYSTEMS		N51.5427	SV04-iC5-1F

Gebrauch Zchg. Usa del disegno	Stueckzahl Numero pezzi	Gegenstand Oggetto	Pos.	Werkstoff Materiale	Gewicht/Stueck Peso/Pezzo	Bestandt. Nr. Elemento Nr.	Bemerkungen Osservazioni
-----------------------------------	----------------------------	-----------------------	------	------------------------	------------------------------	-------------------------------	-----------------------------

Freimass-Toleranzen/Tolleranze della misure libere	Aenderungen: Modifiche: ⓐ				Keine Nessuna Stueckliste separat Lista pezzi separata		Ersetzt durch Sostituito da Ersatz fuer Sostituisce	
	Typ: Tipo:				Massstab Scala 1:1	Gezeichnet Disegnato	VICENTINI	28-10-2008
	INVERTER MOTOR CARRIAGE OP1					Gepueft Controllato	Servisi	23-11-09
					FROMMM			