

Aenderungen:  
 Modifiche:  
 ⓐ  
 Modificata  
 scritta  
 da 0.8Kw  
 a 0.4Kw

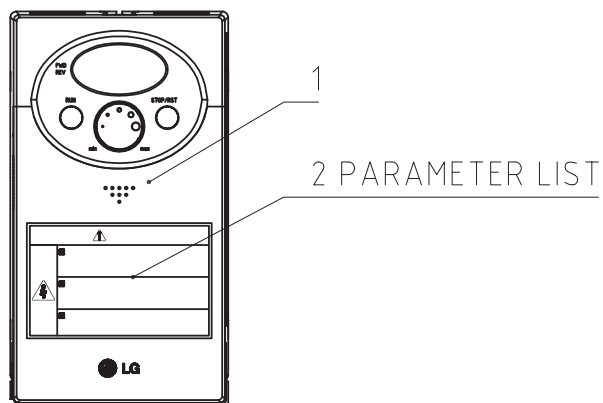

iC5 - 0.4kW - 230V - Carriage OP2 - 25/02/2009 - 14.53.50

-----[DRV]-----  
 Acc 0.1 sec Acceleration time 0  
 Dec 0.1 sec Deceleration time 0  
 Frq 4 Freq. Setting mode

-----[FU1]-----  
 F14 0.1 sec Motor Magnetizing time  
 F22 50.00 Hz Base Frequency  
 F23 0.10 Hz Start Frequency

-----[FU2]-----  
 H33 1.3 A Motor rated current  
 H34 0.8 A No load motor current  
 H40 3 Control mode

-----[IO]-----  
 I12 0.00 mA I input minimum current  
 I55 16 30-A/B/C output working

1	FILE DI PROGRAMMAZIONE	2	PARAMETER LIST			
	INVERTER CARRIAGE OP2	1	LS INDUSTRIAL SYSTEMS		N51.5427	SV04-iC5-1F

Gebrauch Zchg. Usa del disegno	Stueckzahl Numero pezzi	Gegenstand Oggetto	Pos.	Werkstoff Materiale	Gewicht/Stueck Peso/Pezzo	Bestandt. Nr. Elemento Nr.	Bemerkungen Osservazioni
	Rubrik Rubrica						

Freimass-Toleranzen/Tolleranze della misure libere	Aenderungen: Modifiche: ⓐ		Keine Nessuna Stueckliste separat Lista pezzi separata	Ersetzt durch Sostituito da Ersatz fuer Sostituisce
--	------------------------------	--	---	--

Freimass-Toleranzen/Tolleranze della misure libere	Typ: Tipo:	INVERTER MOTOR CARRIAGE OP2	Massstab Scala 1:1	Gezeichnet Disegnato	VICENTINI	28-10-2008
				Gepueft Controllato	Servisi	23-11-09
				Gesehen Visto		

Freimass-Toleranzen/Tolleranze della misure libere	<b>FROMMM</b>	<b>FS3.2188</b>
--	---------------	-----------------