

TECHNICAL DATA SHEET

FS1.0205 - Carriage motor group FS1 "CENTO"

Spring to control belt tension

We have added a spring (1) N2.5159 on the shaft (2) FS1.2057 to ensure, that in case the belt FS1.2065 will loses tension the machine will created an alarm and stops operation. It has been noticed that without spring (1), it could happen that the shaft (2) doesn't activate the sensor N5.2375 and thus doesn't make the alarm. To keep the spring in position an extra hole (3) has been made in the shaft (2) and two extra guides (4) have been cut out from the plate (5) FS1.2044

The modification has been made on all FS1 "CENTO" machines supplied after **15-05-2012**
For older versions pay additional attention during maintenance on this specific point.

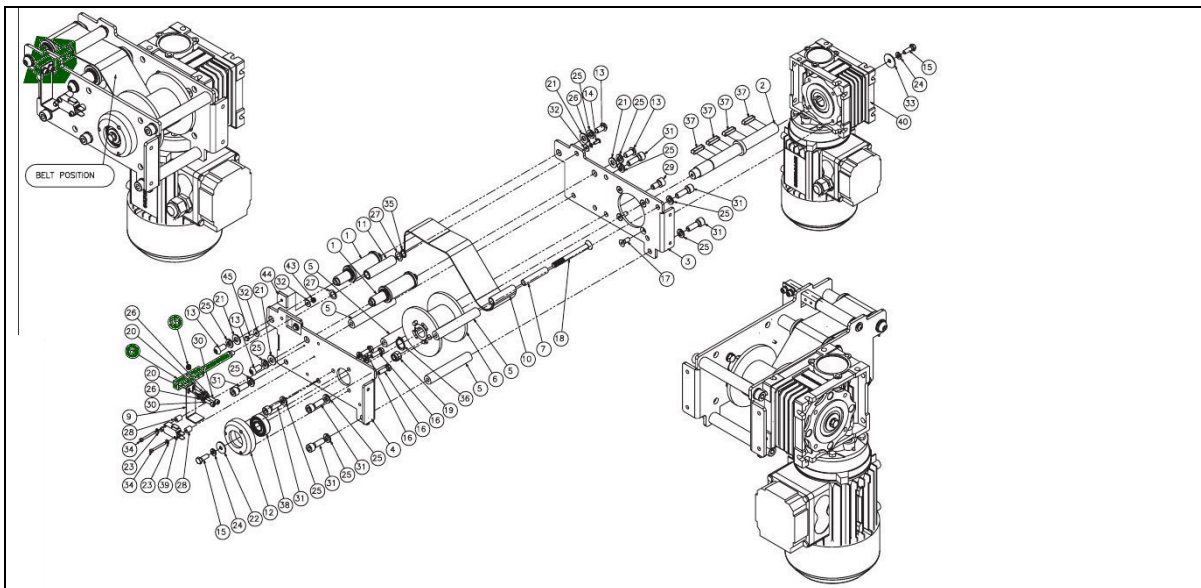
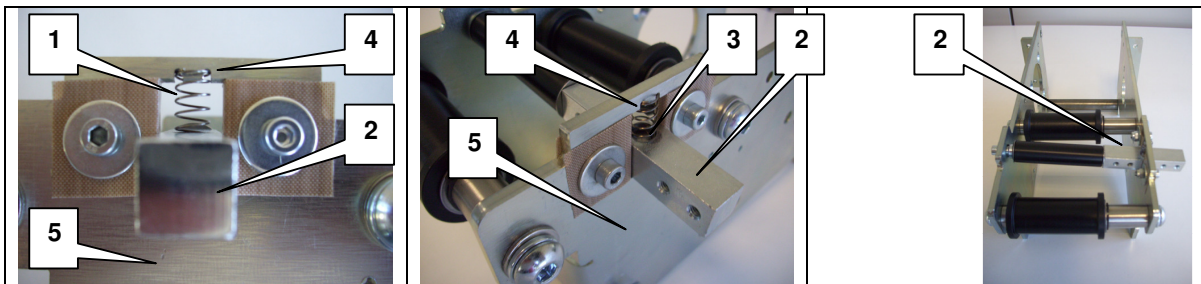

For further information please contact Service Department,
Best Regards,

FROMM Italiana S.r.l. (Stretch wrapping Division)
☎ 0039 045 6245523 ✉ service@fromm-stretch.com